

Scale For Planning Purposes Only				
Rev	Date	Description	Author	
C	2023.12.19	Submission Issue	rf	
D	2024.03.13	Updated as consultee comments	rf	
E	2024.03.14	Brick Screen Walls updated	rf	
F	2024.04.26	Further Updated as FW comments	rf	
G	2024.04.28	Updated as AC comments	rf	
H	2024.04.28	Plots 26-28 Amended	rf	
J	2024.05.07	Plots 32&33 parking amended	rf	
K	2024.10.01	Improvements to gardens and parking	rf	
L	2024.11.20	Garden 119/120 increased	rf	
M	2024.11.27	Coordination Issue	rf	

Enclosures Legend	
	1800mm Screen Wall [Brick Type A - Buff]
	1800mm Screen Wall [Brick Type B - Multi Red]
	1800mm Timber Fence
	1800mm Hit & Miss fence to Bin Stores
	900mm Wall [Brick Type A - Buff]
	1200mm Bow Topped Railings including self closing anti finger trap gates
	1100mm Timber Post and Rail
	1100mm Vertical Railings
	450mm Knee Rail
	1100mm Private Hedge
	1800mm Timber Gate (lockable)
	Proposed Hedgerow
	Retained Hedgerow

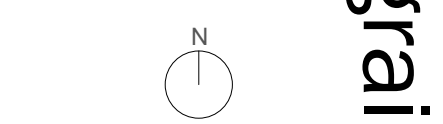
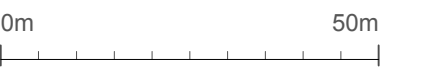

grainge architects

PLANNING

Kithill
Crewkerne
for
Tilia Homes

Enclosures Plan - West

Scale: 1:500 @ A1 [1:1000 @ A3]

Drawing No: 1644 / P125-1 Rev M

The Boat Shed, Michael Browning Way
Exeter, EX2 8DD
01392 438051 mail@g-a.uk.com

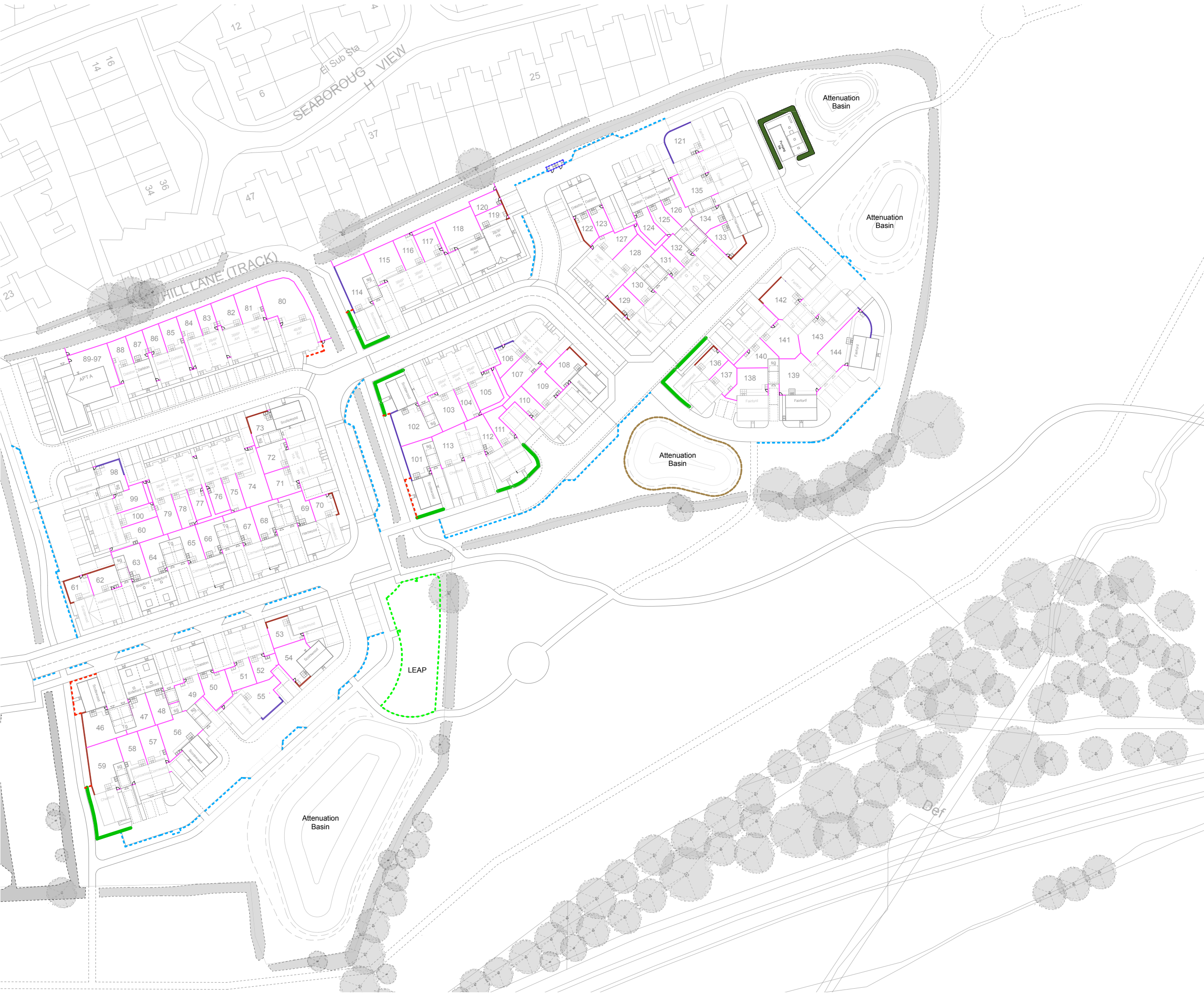

Scale For Planning Purposes Only			
Rev	Date	Description	Author
C	2023.12.19	Submission Issue	rf
D	2024.03.13	Updated as consultee comments	rf
E	2024.03.14	Brick Screen Walls updated	rf
F	2024.04.26	Further Updated as FW comments	rf
G	2024.04.28	Updated as AC comments	rf
H	2024.04.28	POS Highway Updated	rf
J	2024.10.01	Improvements to gardens and parking	rf
K	2024.11.20	Garden 119/120 increased	rf
L	2024.11.27	Coordination Issue	rf

Enclosures Legend	
	1800mm Screen Wall [Brick Type A - Buff]
	1800mm Screen Wall [Brick Type B - Multi Red]
	1800mm Timber Fence
	1800mm Hit & Miss fence to Bin Stores
	900mm Wall [Brick Type A - Buff]
	1200mm Bow Topped Railings including self closing anti finger trap gates
	1100mm Timber Post and Rail
	1100mm Vertical Railings
	450mm Knee Rail
	1100mm Private Hedge
	1800mm Timber Gate (lockable)
	Proposed Hedgerow
	Retained Hedgerow

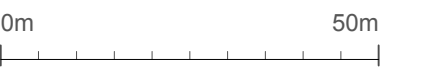

grainge architects

PLANNING

Kithill
Crewkerne
for
Tilia Homes

Enclosures Plan - East

Scale: 1:500 @ A1 [1:1000 @ A3]

Drawing No: 1644 / P125-2Rev L

The Boat Shed, Michael Browning Way
Exeter, EX2 8DD
01392 438051 mail@g-a.uk.com